

**INSTRUCTION SHEET
FOR
VISTA™/ ARJENT™ LED LOWER LEVEL UPGRADE KIT**

SAFETY MESSAGE TO INSTALLERS AND USERS

⚠ WARNING

People's lives depend on your safe installation of our products. It is important to read, understand and follow all instructions shipped with the products. In addition, listed below are some other important safety instructions and precautions you should follow:

- **To properly install this light, you must have a good understanding of automotive systems, along with proficiency in the installation and use of safety warning equipment.**
- **You should frequently inspect the light to ensure that it is operating properly and that it is securely attached to the vehicle.**
- **This product contains high intensity LED devices. To prevent permanent eye damage, DO NOT stare into the light beam at close range.**
- **The light should be frequently inspected to ensure that it is operating properly and that it is securely attached to the vehicle.**
- **File these instructions in a safe place and refer to them when maintaining and/or reinstalling the product.**

Failure to follow all safety precautions and instructions may result in property damage, serious injury, or death to you or others.

A. GENERAL.

⚠ WARNING

This unit is designed for use in the lower level of the Vista and Arjent lightbars. Do not install in any other lightbar.

This is an upgrade LED light head for use in Federal Signal Vista and Arjent lightbars. It is designed to operate on a 12.8 VDC, negative ground

system. The light head can be used as a steady burn light or with a flasher designed for use with LED lights, such as the Federal Signal Intelli-Flash™ or FA3-SC flashers.

B. UNPACKING.

After unpacking the kit inspect it for damage that may have occurred in transit. If the kit has been damaged, do not attempt to install it. File a claim immediately with the carrier, stating the extent of damage. Carefully check all envelopes, shipping labels and tags before removing or destroying them. Ensure that all parts in the KIT CONTENTS LIST have been included.

C. KIT CONTENTS LIST.

Qty	Description
1	LED Light Module
1	Shade
2	Screw, Taptite, #8-32
2	Screw, Hi-Lo, #10
2	Q.D. Terminals, 0.250
1	Wire Harness

D INSTALLATION.

Ensure that all power has been shut off to the lightbar. Wait at least 10 minutes. Remove all domes and proceed as follows:

1. Locate the position where the LED light head is to be installed.
2. Remove any pre-existing light head in the selected position.
3. See figure 1. Snap the light head into place. If the snap features in the plastic tray have been damaged, secure the light head with the supplied #10 Hi-Lo screws.
4. See figure 2. If the light head is installed in right rear or left rear positions, the LED light module can be angled. Remove the two screws that secure the LED light module to the shade. Angle the LED light module as shown. Secure with the previously removed screws.

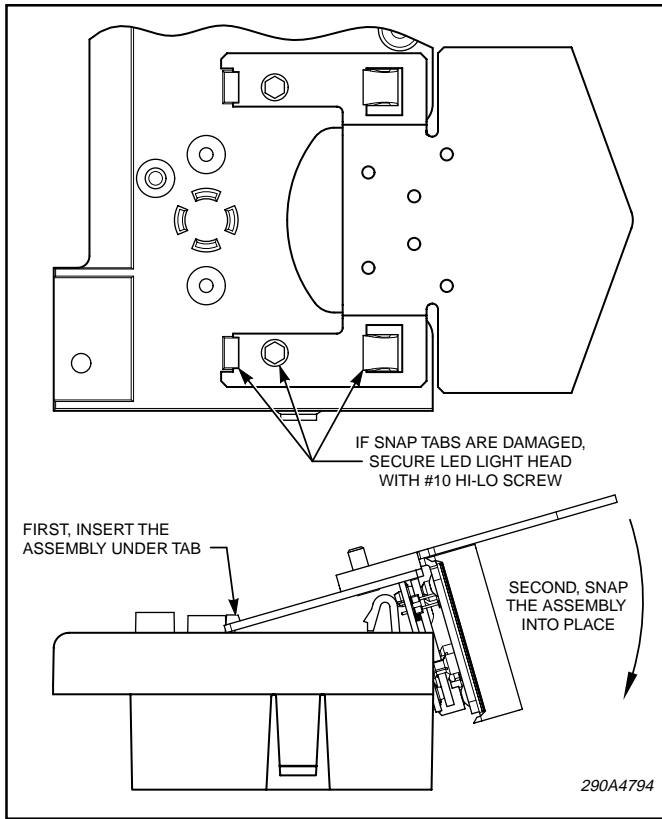

Figure 1.

5. Route the supplied wire harness from the light head to the power connections. Ensure that the wire harness is routed away from hot and/or moving parts.

6. Connect the red and black leads of wire harness as follows:

FA3-SC: Connect the red to a leg (channel) of flasher. Connect the black to ground (-).

Intelli-Flash: Connect the red to common positive (+) input of flasher. Connect the black to channel of flasher (ORANGE or GREEN).

Steady Burn: Connect the red to switched positive (+) input. Connect the black to ground (-).

E. TESTING.

⚠ WARNING

This product contains high output LED devices. To prevent permanent eye damage, do not stare into the light beam at close range.

After installation, check the entire system to ensure the lights are functioning properly and siren/light system functions are operating properly.

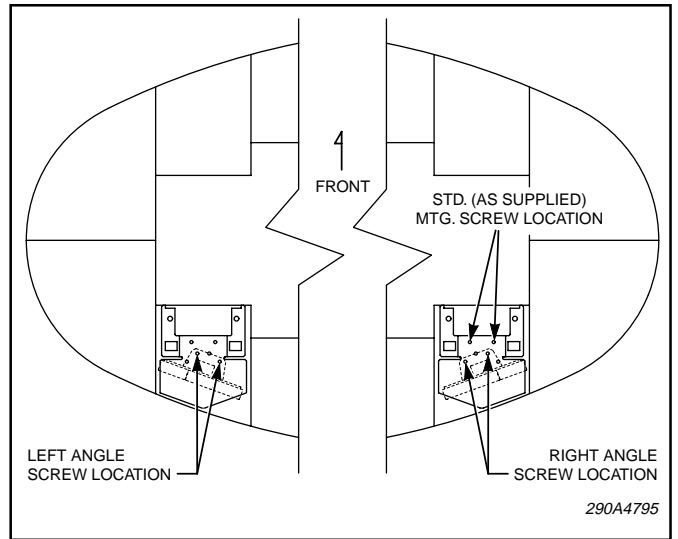

Figure 2.

SAFETY MESSAGE TO OPERATORS

⚠ WARNING

People's lives depend on your safe use of our products. Listed below are some important safety instructions and precautions you should follow:

- **Although your warning system is operating properly, it may not be completely effective. People may not see or heed your warning signal. You must recognize this fact and continue driving cautiously.**
- **Also, situations may occur which obstruct your warning signal when natural or man-made objects are between your vehicle and others, such as: raising your hood or trunk lid. If these situations occur, be especially careful.**
- **This product contains high intensity LED devices. To prevent permanent eye damage, DO NOT stare into the light beam at close range.**
- **At the start of your shift, you should ensure that the light is securely attached and operating properly.**

Failure to follow these safety precautions may result in property damage, serious injury, or death to you, to passengers, or to others.

RETAIN AND REFER TO THIS MESSAGE