

Safety Message to Installers of Warning Light Equipment

▲ WARNING

People's lives depend on your proper installation and servicing of Federal Signal products. It is important to read and follow all instructions shipped with this product and the original product. In addition, listed below are some other important safety instructions and precautions you should follow:

- To properly install a light assembly, you must have a good understanding of automotive electrical procedures and systems, along with proficiency in the installation and use of safety warning equipment.
- When drilling into a vehicle structure, be sure that both sides of the surface are clear of anything that could be damaged.
- You should frequently inspect the light system to ensure that it is operating properly and that it is securely attached to the vehicle.
- Refer to the instruction sheets packed with related products for additional precautions and information.
- File these instructions in a safe place and refer to them when maintaining and/or reinstalling the product.

Failure to follow all safety precautions and instructions may result in property damage, serious injury, or death.

Product Overview

This publication provides supplemental directions for installing the Federal Signal Arjent® Series lightbar with the Load Distribution Kit on a 2011 or newer Dodge Charger. The Load Distribution Kit is designed to prevent vehicle damage due to aerodynamic loading when travelling at speeds in excess of 120 MPH. This kit is designed to work in conjunction with the XAHK-SD (installed at the factory) and XHK-SD (service kit) Arjent Hook-Mounting Bracket Kits (in production from November 2009). –SC and earlier mounts must be upgraded. This kit includes special wide gutter hooks.

Unpacking the Kit

After unpacking the kit, inspect it for damage that may have occurred in transit. If it has been damaged, do not attempt to install or operate it. File a claim immediately with the carrier, stating the extent of damage. Carefully check all envelopes, shipping labels, and tags before removing or destroying them. Ensure that the parts in the Table 1 are included in the package. If you are missing any parts, contact Customer Support at 1-800-264-3578, 7 a.m. to 5 p.m., Monday through Friday (CT).

Table 1 Kit contents (continued on next page)

Qty.	Description	Part Number
5	Pad, Mounting, Rubber	8572029
10	Screw, #10, Type B Pan Torx, Black, SS	7011246-08
8	Screw, 5/16"-18 x 7/8 Pan Torx, Black SS	7000434-14
8	Washer, 5/16" Flat, Black SS	7072234
8	Lockwasher, 5/16" Flat, Black SS	7074A020-01

Table 1 Kit contents (continued from previous page)

Qty.	Description	Part Number
2	Pad, Hook Bumper	8552492
2	Hook, Special Gutter, 2011 Charger	855200044
1	Foot Assy., Adjuster, Wide, Rear Pass. Side	858300041
1	Foot Assy., Adjuster, Wide, Rear Driver. Side	858300042
2	Strap, Limit	858300043

Installing the Wide Foot Assembly Adjuster

To install the wide adjuster:

1. See Figure 1. Before proceeding, note the difference between the -SD Mounting Bracket Assembly and the -SC and earlier mounting.

Figure 1 -SD Mounting bracket identification

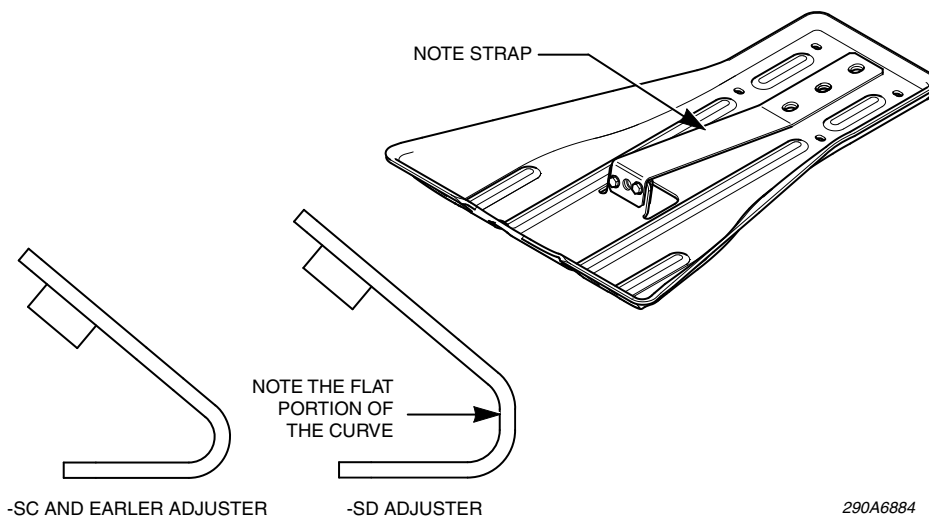

2. Cut one rubber hook-bumper pad in half as shown in Figure 2.

Figure 2 Rubber pad cut in half

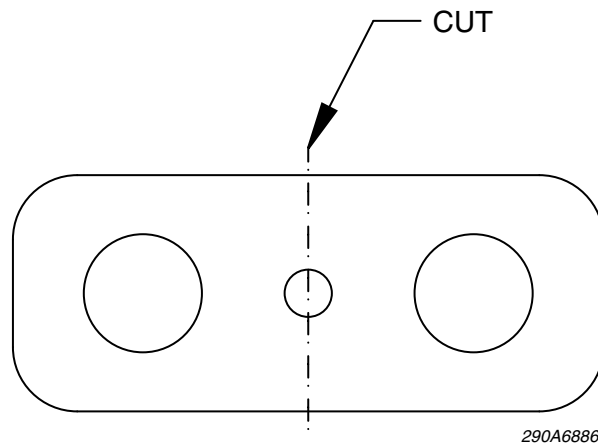

3. See Figure 2 on page 2. Install one full pad and one half pad onto each wide adjuster foot assembly.
4. Use the 5/16"-18 x 7/8" Torx head screws, 5/16" flat washers, and 5/16" lockwashers to loosely attach a wide adjuster foot assembly on the rear of the mounting bracket

Figure 3 Pads installed on -SD wide adjuster

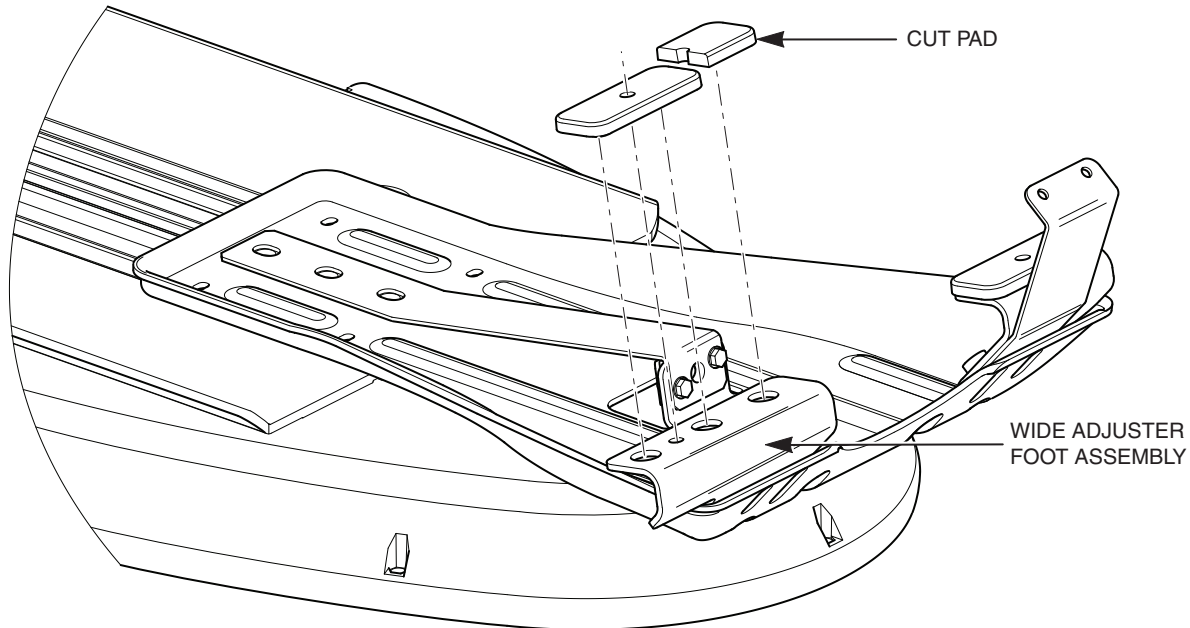

290A6887

5. See Figure 3 above and Figure 1 on page 2. Sandwich the limit strap between the -SD adjuster and front of the mounting bracket, loosely attached with the 5/16"-18 x 7/8" Torx head screws, 5/16" flat washers, and 5/16" lockwashers.
6. Repeat steps 1 through 5 for other side of the lightbar.
7. See Figure 4 on page 4. Position the lightbar and the special wide gutter hook on the roof as shown. Mark, then drill, five 0.136" (#29) holes on each side for the gutter hook and limit strap.
8. Complete the installation with the hardware and instructions supplied in this kit and with the XAHK-SD or XHK-SD mounting bracket kit.

Figure 4 Lightbar secured to vehicle



Getting Technical Support and Service

For technical support and service, please contact:

Federal Signal Corporation

Service Department

Phone: 1-800-433-9132

Fax: 1-800-343-9706

Email: empserviceinfo@fedsig.com